



# Instructions for Bleach Sprayer 70151B & 70152B

Customer service is here to help! If you have any questions or concerns, do not return sprayer to the store.  
Call 1-800-9-SPRAYER or email ladybug@hdhudson.com

**THANK YOU!** We appreciate the trust and confidence you have placed in HDX through the purchase of this sprayer. We strive to continually create quality products designed to enhance your home. Visit us online to see our full line of products available for your home improvement needs.

Thank you for choosing HDX!

## SAFETY INFORMATION

<b>WARNING:</b> This product is designed to spray chemicals that may be harmful and could cause serious personal injury if inhaled or brought into contact with the user. Failure to read and follow these instructions before use and/or misuse of this product could result in explosive failure with major injuries.	<b>WARNING:</b> Do not store liquids in the sprayer.	<b>WARNING:</b> Never fill above the maximum fill line on the tank.
<b>WARNING:</b> Always wear long sleeve shirts, long pants, goggles, gloves, and durable shoes when using this product.	<b>WARNING:</b> Always read and follow the label instructions for the chemicals to be applied.	<b>WARNING:</b> Do not alter the sprayer or any components.
<b>WARNING:</b> Always wear long sleeve shirts, long pants, goggles, gloves, and durable shoes when using this product.	<b>WARNING:</b> Always test the sprayer before each use.	<b>WARNING:</b> Always release the pressure in the sprayer before servicing.
	<b>WARNING:</b> After each use, release the pressure and clean the sprayer.	

## CARE AND CLEANING

- Do not store chemicals in the tank. If the chemical is stored in the tank, it can clog the system as it dries and destroy the seals and other components.
- To prolong the life of the sprayer, clean the sprayer after each use. After using any products, including chemical and water-based products, rinse thoroughly with soapy water followed by clean water. Always flush out the hose and flow control. You do not need to take the flow control apart to clean it.
- To store the sprayer, remove the complete hose assembly (hose with siphon tube, wand and flow control) from the tank.
- For proper drainage and drying, lock the flow control lever in the on position.
- Loosen the pump assembly, but leave in the tank when storing.
- Store all components in a clean, dry area.

## PRE-ASSEMBLY

### PACKAGE CONTENTS

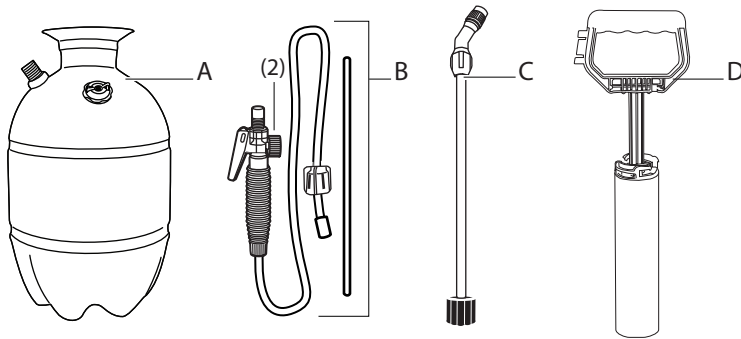

If you don't see all of the parts listed below in your box, don't return your sprayer to the store. Call us at 1-800-9-SPRAYER

Part	Description	Quantity
A	Tank	1
B (2)	Hose assembly & flow control	1
C	Wand	1
D	Pump assembly	1

## CHEMICAL RECOMMENDATIONS

Recommended for use with:

- ✓ Bleach
- ✓ Most chemical weed killers
- ✓ Most chemical insecticides/pesticides
- ✓ Mild cleaners (such as dishwashing detergent, and most disinfectants)

Some sprayers can handle tougher chemicals. Call or email us for a recommendation for your project!

1-800-9-SPRAYER  
ladybug@hdhudson.com

We do not recommend this, or any sprayer, to be used with the following:

- Flammable Products (gasoline, diesel fuel, hydraulic oil, etc.)
- Hot or Boiling Liquids
- Highly Viscous (thick) materials (tar, high-solid paint or stain)
- Paint and Stains
- Citrus-Based Cleaner
- Strong Acids or Bases
- Strong Solvents
- Lacquers or Lacquer Thinners
- Turpentine
- Products containing Peppermint Oil or Peanut Oil
- Epsom Salt
- Mineral Spirits
- Vinegar
- Essential Oils

## WARRANTY

**WHAT IS COVERED** The supplier warrants to the original purchaser only that the product purchased will continue to function as intended if use in accordance with operating instructions (under NORMAL CONSUMER USE) for length of the warranty. If the product fails to function as intended--DO NOT RETURN IT TO THE STORE-- call our Customer Service Team at 1-800-9-SPRAYER for fast service. We will, at our opinion, repair or replace any non-functioning parts without charge (shipping and handling charges will apply). This warranty does not apply to damage resulting from accident, misuse, neglect, alterations, operation not in accordance with instructions, commercial use, or normal wear of O-rings, seals or gaskets. Repair or replacement of the non-functioning product or part. The supplier excluded liability under this warranty for any and all incidental and consequential damages, so these limitations or exclusions may not apply to state.

### ASSEMBLY

#### 1 Attaching the hose to the tank

- Push the supply tube into the threaded tank nipple on the tank until fully seated.
- Screw the hose nut onto the threaded tank nipple. Firmly hand tighten and pull to ensure a tight connection.

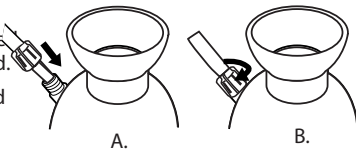

#### 2 Attaching the wand to the flow control

- Push the wand into the flow control all the way into the shoulder.
- Slide the wand nut onto the flow control and firmly hand tighten.
- To ensure the correct assembly, test the sprayer with water before first use.

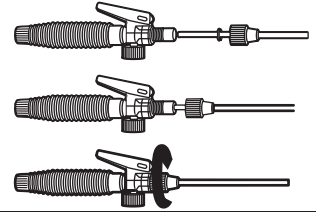

### OPERATION

#### 1 Filling the sprayer

**WARNING:** Do not spray flammable, caustic (i.e. acids, chlorines and bleach), corrosive, heated or self-heating solutions with this sprayer.



- Remove the pump assembly from the tank by locking the pump handle down, then turning counterclockwise.
- Prepare the spray solution following the instructions listed on the chemical manufacturer's label. Mix only the amount of solution to be sprayed and never fill the tank above the maximum fill line (MAX FILL LINE).
- Screw the pump assembly back into the tank by turning clockwise. Firmly hand tighten.

#### 2 Pressurizing the sprayer

**WARNING:** Always close the pressure release valve when pressurizing the sprayer.

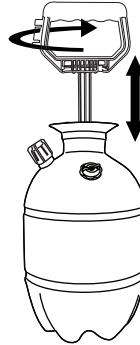

- WARNING:** To prevent the ejected pump assembly and/or solution from striking and injuring you, never stand with your face or body directly over the top of the tanks when pumping or loosening the pump.
- To operate the pump unlock the pump handle by turning counterclockwise. Be careful not to loosen the pump from the tank.
- To create pressure, move the pump handle up and down until it is hard to pump.
- Lock the pump handle back into the pump assembly by turning clockwise.

#### 3 Operating the sprayer

**WARNING:** Do not loosen or remove the flow control cap (2) while spraying. The flow control cap does not regulate or adjust pressure or liquid flow rate.

**CAUTION:** Always wear long sleeve shirts, long pants, goggles, gloves and durable shoes.

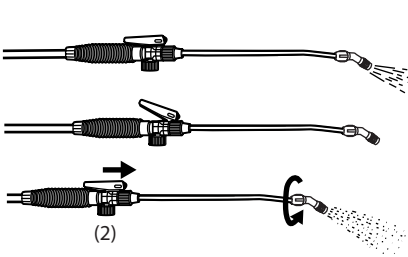

- To start spraying, squeeze the lever on the flow control.
- To stop spraying, release the lever on the flow control.
- To spray continuously, squeeze the lever on the flow control and slide forward to lock in place. Slide trigger back down to shut flow control off.
- Screw the nozzle clockwise for a fine mist and counter clockwise for a straight stream. Switch out nozzle for a high or low volume flat fan.

#### 4 Releasing pressure from the tank

**WARNING:** Always release pressure in sprayer before servicing.

**WARNING:** Never leave a pressurized sprayer unattended.

Your sprayer has a pressure relief valve, turn the black knob clockwise until all air pressure is gone.

A click to the right releases pressure. Another click to the right closes it to build pressure again.

The pressure relief valve should only be turned to the right and never to the left.



### MAINTENANCE & TROUBLESHOOTING

To keep the pump working smoothly and efficiently, the plunger gasket needs to be lubricated often by applying a lubricant, such as petroleum jelly, around the outside of the plunger gasket.

#### 1. Remove pump assembly from the tank.

#### 2. Unlock the pump handle and pull it out as far as it will go.

#### 3. With a flat head screwdriver, push down on the tabs on each side of the pump to release the locking cap.

a. Pull up on the handle and the plunger assembly should come out of the pump cylinder.

b. Spread a generous amount of lubricant on the outer edge of plunger gasket.

#### 4. To reassemble, insert the plunger assembly into the cylinder and snap the cap back into place.

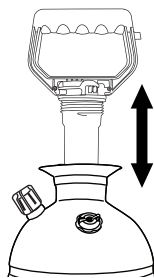

Problem	Probable Cause	Solution
The spray solution or air leaks into the pump cylinder.	The check valve on the bottom of the cylinder is unable to seal properly due to dirt, residue, or damage.	Remove the pump assembly and examine the check valve. Clean if dirty; replace if necessary. For spare parts, call 1-800-9-SPRAYER
The hose leaks air at the tank connection.	The tank nut is loose or the hose insert O-ring is damaged.	Unscrew hose nut from tank and ensure that the hose is pushed all the way into the tank up to the ridge in the hose. Make sure the O-ring is properly seated and not damaged. Tighten the hose tank nut or replace the hose O-ring.
There is a bad spray pattern or low spray volume.	The nozzle is clogged, the nozzle is tightened too far, or the pressure is low in the sprayer.	Slowly turn nozzle counterclockwise to ensure it is open. If still low spray volume, remove the nozzle, the diffuser, and clean. Remove the wand and clean. If the wand cannot be unclogged, replace it or repressurize the tank.
There is a leak at the tank opening.	The pump assembly is not sealed tightly into the tank. The Cylinder O-ring is damaged.	Thoroughly clean the pump cylinder O-ring and surrounding area and apply grease or petroleum jelly to the pump O-ring. Replace the O-ring. For spare parts, call 1-800-9-SPRAYER
Fluid leaks from the pressure relief valve.	The tank is over filled.	Release the pressure by following the "Releasing pressure from the Tank" instructions in the Operation section.
Air leaks from the pressure relief valve.	The pressure release valve is stuck in the open position.	Turn the pressure release valve clockwise until it clicks and reseats itself.